

JAP Series Deep Well

The Davies Pumps JAP series are a self-priming deep well style pump with separate jet & venturi assembly to allow operation when water source is up to 50m below the pump or a long distance away. Ideal for pumping from water sources such as bores, well or rivers with flood risk or remote power supplies. They use a rugged cast iron casing close coupled to air cooled electric motor for simple installation and a long service life. The 1.0 hp model has a single impeller design for a cost effective solution best suited to tank filling and the larger models use twin impellers to allow higher pressures and flows.

Pump Features

- Separate Deep Well Jet and Venturi Housing
- Cast Iron Housings
- Robust and reliable
- Suction depths of more than 8m
- Maximum liquid temperature 60 degrees



JAP SERIES

| DAVIES JB SERIES | | | | | |
|------------------|-----|---------|-------|-------|------|
| Model | HP | KW (P2) | Volts | Phase | Amps |
| JAP102M | 1.0 | 0.74 | 230 | 1 | 4.1 |
| JAP151M | 1.5 | 1.1 | 230 | 1 | 7.9 |
| JAP151T | 1.5 | 1.1 | 400 | 3 | 3.5 |
| JAP201M | 2.0 | 1.5 | 230 | 1 | 10.3 |

Construction Material:

- Pump body: Cast iron G20 with anti-corrosive coating.
- Motor bracket: In die casting aluminium UNI 5076 and stainless steel Aisi 304 (cast iron for Jap 150-200).
- Ejector: Cast iron G20 with anti-corrosive coating.
- Diffuser, Nozzle & Venturi tube: GE Noryl® GFN2.
- Impellers, GE Noryl GFNZ (stamped brass UNI-EN 12165 standard for model 151-201).
- Pump shaft: Stainless steel Aisi 420A.
- Mechanical seal: Carbon-ceramic.

Installation:

- Before installing the pump, verify that all the pipes are clean inside to avoid any obstruction in the ejector nozzle.
- A foot valve must be installed at the foot of the ejector.
- After the pump is installed, fill pipes with clean water.
- To preserve an efficient priming a specific pressure in the circuit is necessary – a gate valve on the discharge can achieve this.
- Note: Minimum pump operating heads must be observed.

Single impeller 1.0hp model

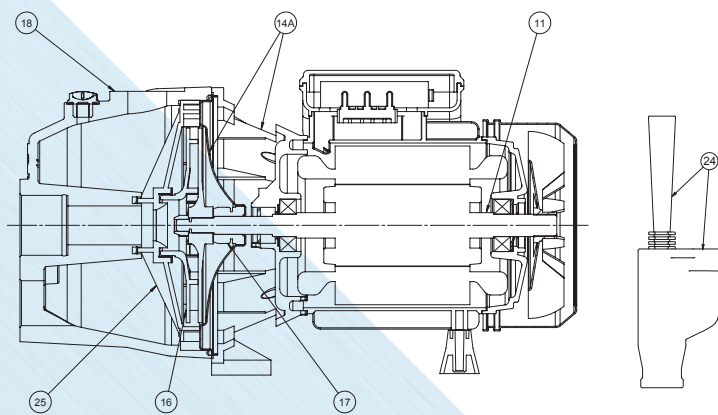

- 11. Pump shaft + rotor
- 14A. Motor bracket kit
- 16. Impeller
- 17. Mechanical seal
- 18. Pump body
- 24. Complete ejector
- 25. Diffuser

Twin impeller 1.5hp and 2.0hp models

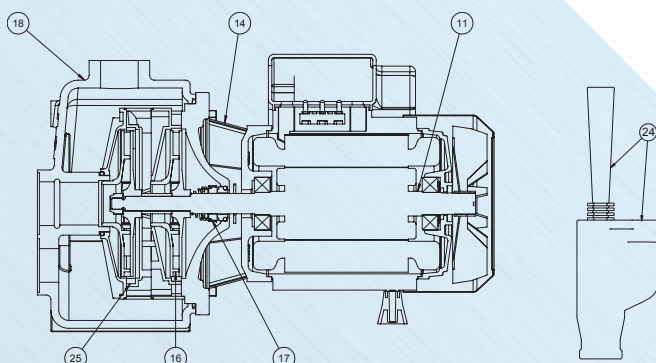

- 11. Pump shaft + rotor
- 14. Outlet bracket
- 16. Impeller
- 17. Mechanical seal
- 18. Pump body
- 24. Complete ejector
- 25. Diffuser

DIMENSIONS

Single impeller 1.0hp model

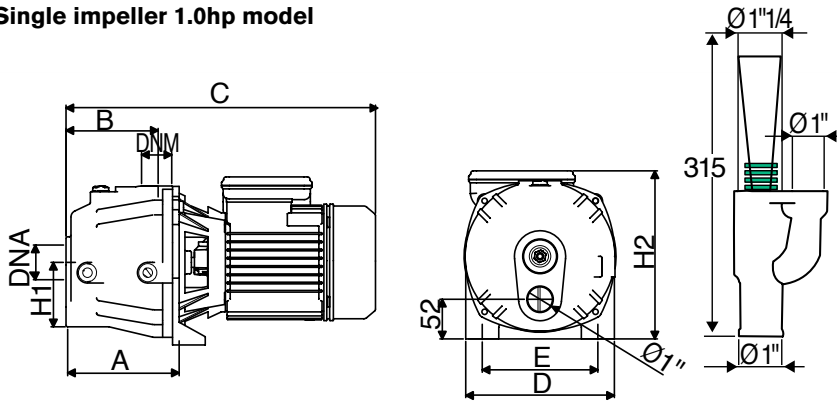

Twin impeller 1.5hp and 2.0hp models

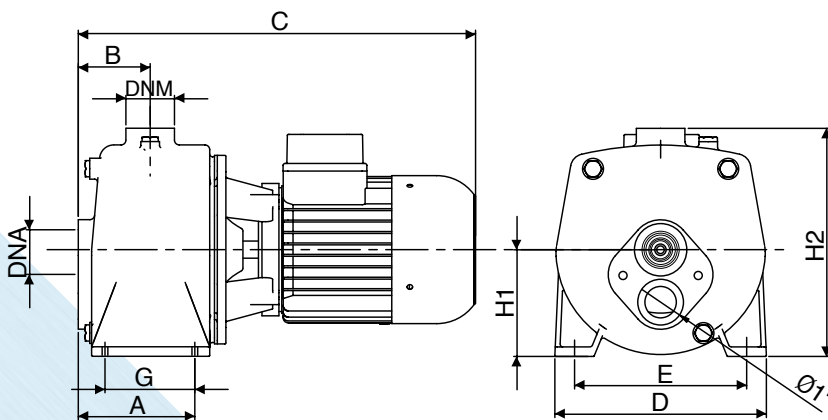

DIMENSIONS AND SPECIFICATIONS

| Model | A | B | C | D | E | G | H1 | H2 | DNR | DNM | Hg |
|---------|-----|----|-----|-----|-----|-----|-----|-----|-------|-----|------|
| JAP 101 | 160 | 85 | 370 | 180 | 140 | - | 100 | 188 | 1 1/4 | 1" | 14.3 |
| JAP 151 | 125 | 74 | 415 | 226 | 174 | 104 | 120 | 248 | 1 1/4 | 1" | 27.3 |
| JAP 201 | 125 | 74 | 415 | 226 | 174 | 104 | 120 | 248 | 1 1/4 | 1" | 28.9 |