



This is a pump used for domestic hot water boosting. Recommended for use with low pressure or gravity fed domestic pressure system.

The pump is characterised by -

- Automatic operation controlled by flow switch
- Circulation body materials suitable for potable water
- 1 speed operation
- Flows to 30 l/min
- Heads to 9m

Liquid temperature: Maximum 60°C  
Materials: Pump body: Stainless Steel 304  
Impeller: Corrosion resistant composite PPO  
Back Plate and Rotor Can: Stainless Steel 304  
Unions: Stainless Steel 304

Installation: Maximum ambient temperature: 40°C  
Maximum Operating Pressure: 6 bar  
Port spacing: 160mm  
Port size: 3/4" BSPM  
(1/2" BSPM if used with supplied unions)

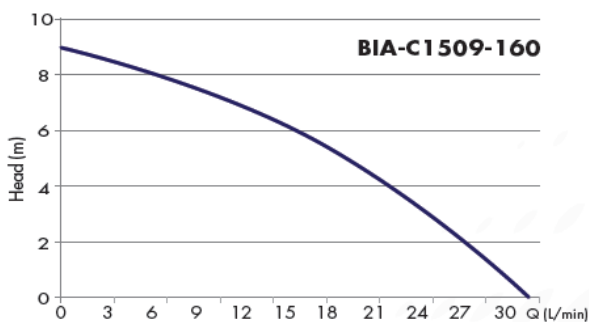

Electrical Data: 230V  
Mains Frequency: 50Hz  
Power consumption speeds: 120W  
Motor: Continuous  
Motor type: Canned rotor  
Ingress Protection: IP42  
Power cable: 1m

**Bianco Pumpz 2 Year Warranty**

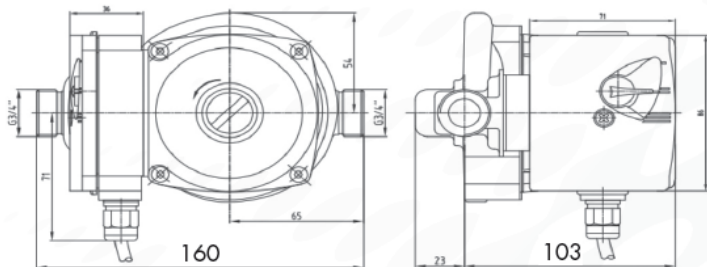

Also available  
BIA-C2060-150  
BIA-C2580-180  
BIA-ICIRC150